



Parcel: 17-091-11-14-005-000

Year: 2023

JACK RESER

Logan County Auditor | Logan County, Ohio



SUMMARY

Table with property details: Deeded Name (KATHY M SMITH), Owner (SMITH KATHY M), Taxpayer (SMITH KATHY M), Tax District (17-LAKE TWP BELLEFT CORP), School District (BELLEFONTAINE C S D), Land Use (499-OTHER COMMERCIAL STRUCTURES), Legal (09111), Routing Number (14005), Sales Amount (0.00).

VALUE

Table with columns: District (17-LAKE TWP BELLEFT CORP), Land Use (499-OTHER COMMERCIAL STRUCTURES), Appraised, Assessed. Rows include Land, Improvement, Total, CAUV, Homestead, OOC, Taxable.

CURRENT CHARGES

Table with columns: Full Rate (71.280000), Effective Rate (49.601016), Qualifying Rate (42.430831), and a breakdown of charges by category (Tax, Special, Total, Paid, Due).

TRANSFER HISTORY

Table with columns: Date, Conveyance, Deed Type, Sales Amount, Valid, # of Properties. Shows transfers on 03/15/2023 and 08/19/2002.

LAND

Table with columns: Type (L1-FRONT LOT), Dimensions (55.0000 X 109.0000), Description (Effective - Frontage / Depth), Value (6,040).

DWELLING

Table with columns: Card 1, Style (1-CONVENTIONAL), Rooms (Family, Dining, Full, Half, Other), Heating, Cooling, Grade, Fireplace Openings, Stacks, Living Area, Total Area, Value (43,990).

OTHER IMPROVEMENT

Table with columns: Card Type (84-CONC PAVING), Year Built (1985), Condition (A-AVERAGE), Dimensions, Description (Length x Width), Size (2,500), Value (3,710).

UTILITIES

Table with columns: Water, Sewer, Electric, Gas, Well, Septic.

SKETCH

Card 1

ID	Description	Size	Floor	Floor Area (ft ²)	Living Area (ft ²)
B	MS (MASONRY STOOP)	72	First Floor	864	864
C	1SFR/.5B (1 STORY FRAME / .5 BASEMENT)	864	Basement	432	0
D	2CFG (2 CAR ATTACHED FRAME GARAGE)	624	Total	1,296	864
1	84-CONC PAVING	2,500			

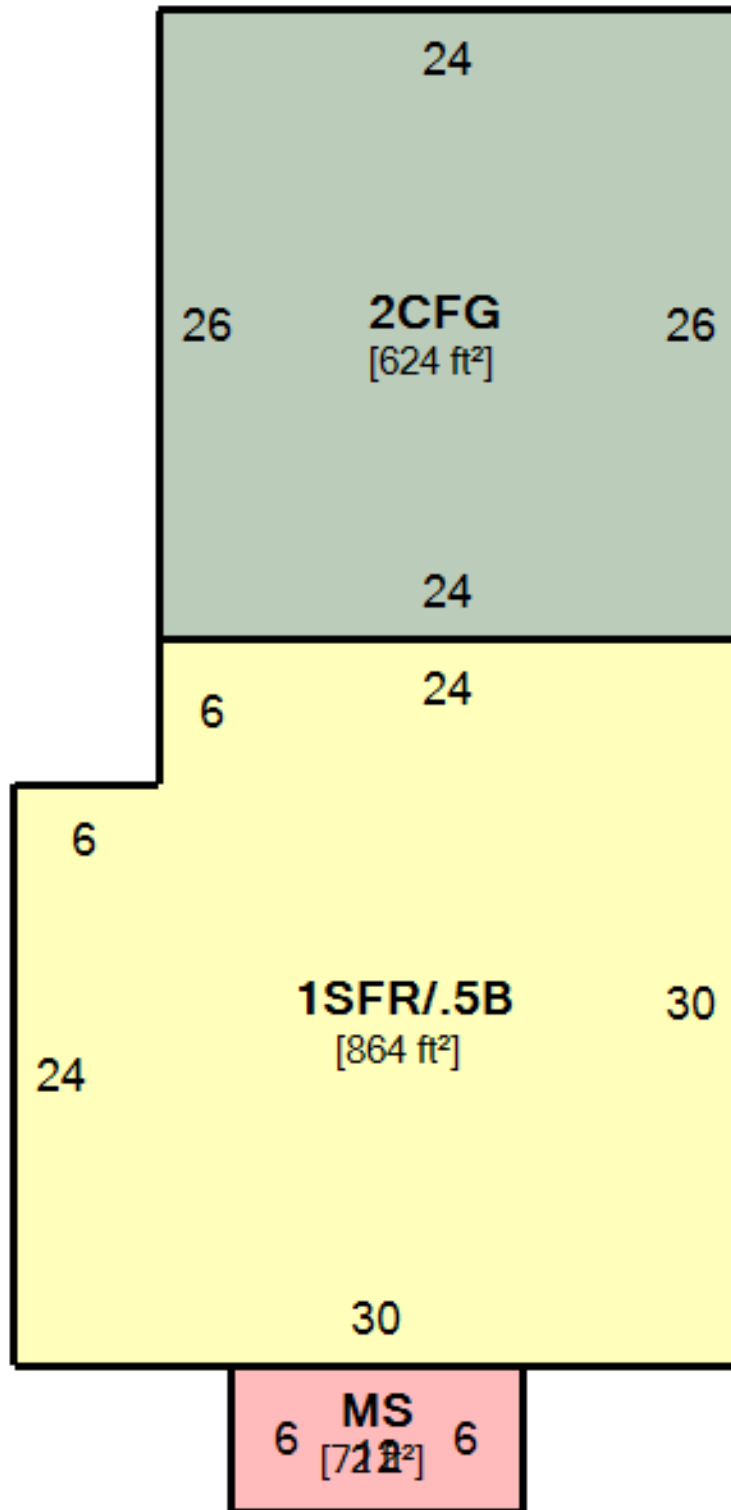

1