

PARID: 068 00104 0023
PARCEL LOCATION: 40 MAPLE AVE

NBHD CODE: 98021100

[Click here to view neighborhood map](#)

Owner

Name

HUMPHRIES RUTH M

Mailing

Name HUMPHRIES RUTH M

Mailing Address 40 MAPLE ST

City, State, Zip DAYTON, OH 45459

Legal

Legal Description 103 WEIDNERS

Land Use Description R - SINGLE FAMILY DWELLING, PLATTED LOT

Acres .2796

Deed DEED-06-037433

Tax District Name WASH-CENTERVILLE CTY

Sales

| Date | Sale Price | Deed Reference | Seller | Buyer |
|-----------|------------|------------------------------|------------------|----------------------------|
| 22-JAN-02 | | | STEPHENS REECE A | STEPHENS REECE A TR AND |
| 27-APR-06 | \$179,900 | 200600037433 | STEPHENS REECE A | HUMPHRIES RUTH M TR AND |

Values

| | 35% | 100% |
|--------------|--------|---------|
| Land | 12,730 | 36,360 |
| Improvements | 40,610 | 116,040 |
| CAUV | 0 | 0 |
| Total | 53,340 | 152,400 |

Building

| | |
|---------------------------------------|-----------------------|
| Exterior Wall Material | FRAME |
| Building Style | RANCH |
| Number of Stories | 1 |
| Year Built | 1951 |
| Total Rms/Bedrms/Baths/Half Baths | 6/2/2/0 |
| Square Feet of Living Area | 2,065 |
| Finished Basemt Living Area (Sq. Ft.) | 0 |
| Rec Room (Sq. Ft.) | 0 |
| Total Square Footage | 2,065 |
| Basement | NONE |
| Central Heat/Air Cond | CENTRAL HEAT WITH A/C |
| Heating System Type | HOT AIR |
| Heating Fuel Type | GAS |
| Number of Fireplaces(Masonry) | 1 |
| Number of Fireplaces(Prefab) | |

Current Year Special Assessments

| | |
|------------------------------------|---------|
| 11777-APC FEE | \$22.58 |
| 41100-MCD/AP MCD/AQUIFER PRES SUBD | \$1.47 |

Current Year Rollback Summary

| | |
|------------------------|-------------|
| Non Business Credit | -\$392.70 |
| Owner Occupancy Credit | -\$98.20 |
| Homestead | -\$626.54 |
| City of Dayton Credit | \$0.00 |
| Reduction Factor | -\$1,872.08 |

Tax Summary

| Year | Prior Year | Prior Year Payments | 1st Half Due 2/16/2018 | 1st Half Payments | 2nd Half Due 7/20/2018 | 2nd Half Payments | Total Currently Due |
|------|-------------|---------------------|---------------------------|-------------------|---------------------------|-------------------|---------------------|
| 2017 | \$19,975.70 | \$0.00 | \$1,769.24 | \$0.00 | \$1,607.06 | \$0.00 | \$23,352.00 |

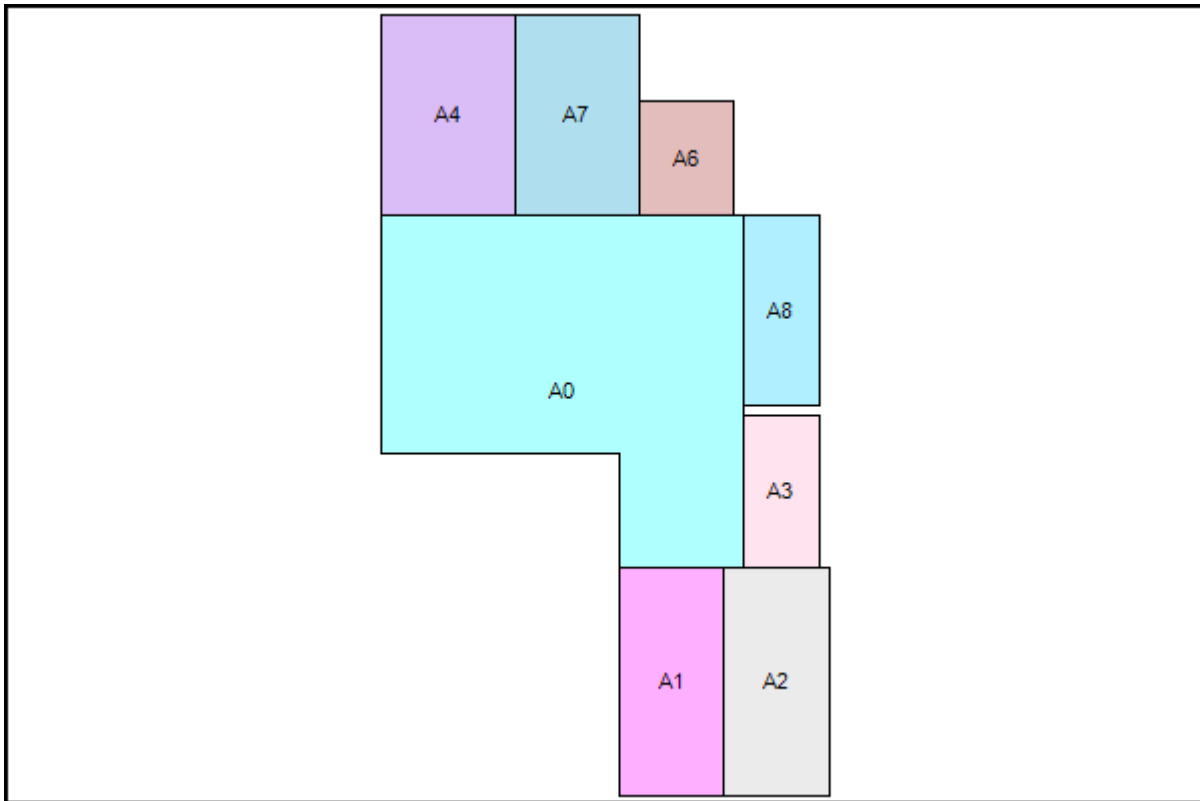

PARID: 068 00104 0023
PARCEL LOCATION: 40 MAPLE AVE

NBHD CODE: 98021100

Residential Property Data

| | |
|-------------------------------|-----------------------|
| Building Style | RANCH |
| Exterior Wall Material | FRAME |
| Number of Stories | 1 |
| Year Built | 1951 |
| Total Rooms | 6 |
| Bedrms | 2 |
| Baths | 2 |
| Half Baths | 0 |
| Square Feet of Living Area | 2,065 |
| Finished Basement Sq. Ft. | 0 |
| Rec. Room Sq. Ft. | 0 |
| Total Square Footage | 2,065 |
| Basement | NONE |
| Central Heat/Air Cond | CENTRAL HEAT WITH A/C |
| Heat System | HOT AIR |
| Heating Fuel Type | GAS |
| Number of Fireplaces(Stacked) | 1 |
| Number of Fireplaces(Prefab) | |

Out Building

| | |
|---------------|--------------------|
| Improvement | FRAME UTILITY SHED |
| Quantity | 1 |
| Size (sq. ft) | 120 |
| Year Built | 2000 |
| Grade | C |
| Condition | AVERAGE |
| Value | 0 |

PARID: 068 00104 0023
PARCEL LOCATION: 40 MAPLE AVE

NBHD CODE: 98021100

| Tax Year | Total Value |
|----------|---|
| 2000 | 106,830 |
| 2001 | 106,830 |
| 2002 | 117,680 |
| 2003 | 117,680 |
| 2004 | 117,680 |
| 2005 | 129,450 |
| 2006 | 129,450 |
| 2007 | 129,450 |
| 2008 | 143,010 |
| 2009 | 143,010 |
| 2010 | 143,010 |
| 2011 | 145,090 |
| 2012 | 145,090 |
| 2013 | 145,090 |
| 2014 | 144,860 |
| 2015 | 144,860 |
| 2016 | 144,860 |
| 2017 | 152,400 |
| 2018 | 152,400 *** TENTATIVE VALUES CURRENTLY UPDATING *** |

PARID: 068 00104 0023**PARCEL LOCATION: 40 MAPLE AVE****NBHD CODE: 98021100****Tax Detail**

Taxes for Selected Year (Without Payments)

| 1st Half Real | 1st Half Asmt | 1st Half Total | 2nd Half Real | 2nd Half Asmt | 2nd Half Total | Total |
|------------------|------------------|-------------------|------------------|------------------|-------------------|------------|
| \$1,596.31 | \$12.09 | \$1,608.40 | \$1,596.31 | \$10.75 | \$1,607.06 | \$3,215.46 |

Current Taxes Due

| | Charges | Payments | Penalties | Interest | Unpaid Balance |
|-----------|-------------|----------|-----------|----------|----------------|
| 1st Half | \$21,584.10 | \$0.00 | \$160.84 | | \$21,744.94 |
| 2nd Half | \$1,607.06 | \$0.00 | \$0.00 | \$0.00 | \$1,607.06 |
| Full Year | \$23,191.16 | \$0.00 | \$160.84 | \$0.00 | \$23,352.00 |